

Electrical cabling - 24 V Open / Close valve, external KaController

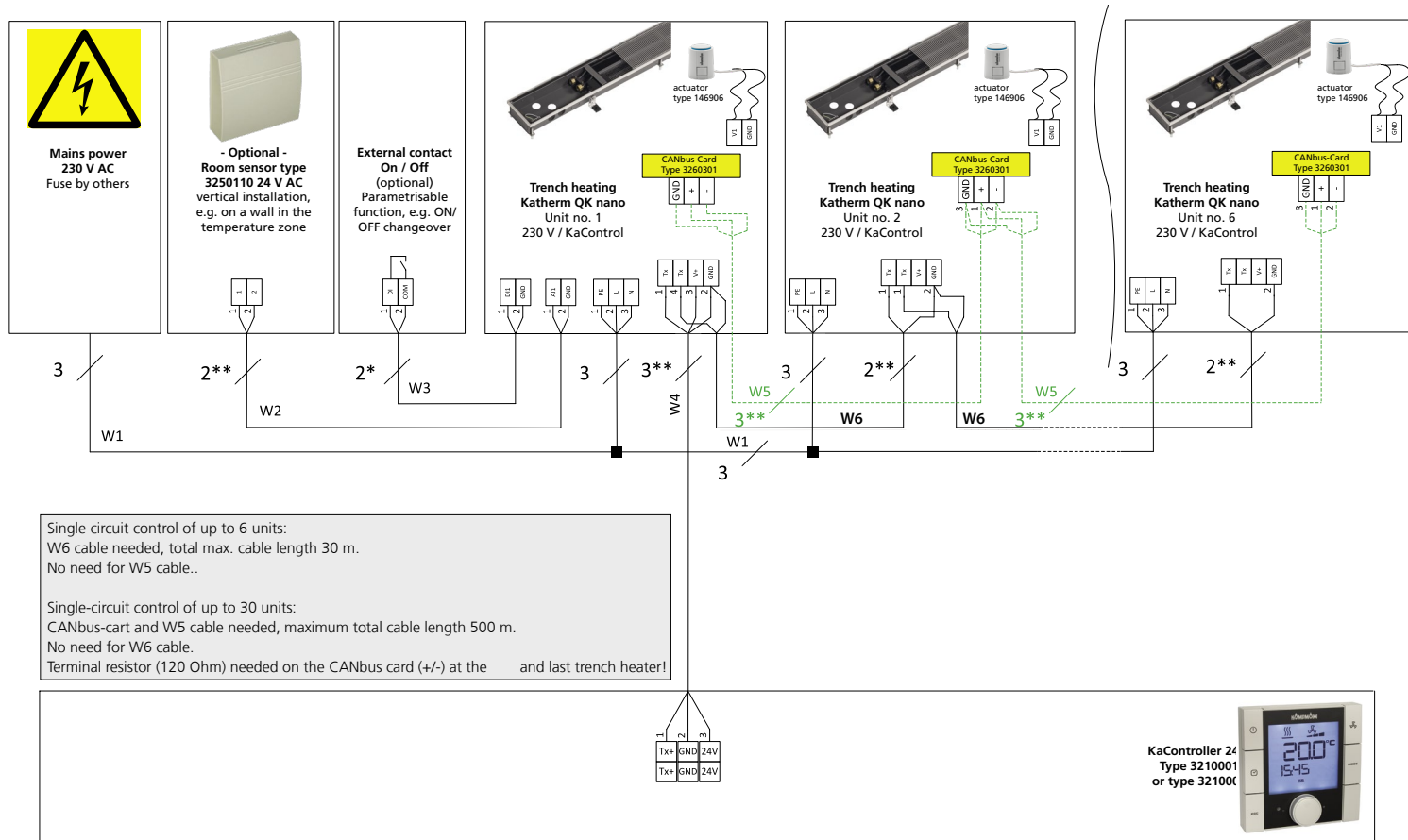

- * Lay shielded cables (e.g. IY(STY) 0,8 mm) separately from high-voltage cables.
 - ** Lay shielded, paired cables, e.g. UNITRONIC@ BUS LD 2x2x0,22 or equivalent, separately from high-voltage cables.
 - W1: Power supply
 - W2: Analogue input AI1 (optional connection), max. cable length 10 m, from 1 mm² 30 m.
 - W3: Digital input DI1 (optional connection), max. cable length 30 m, from 1 mm² 100 m.
 - W4/W6: Bus signal (tLan), each max. total cable length 30 m.
 - W5: Bus signal (CANbus) only needed in a single-circuit control of up to 30 units.
- Subject to technical modifications: Refer to the control accessory documentation in the event of deviation from the circuit diagrams!

KaControl electrical cabling - BMS control

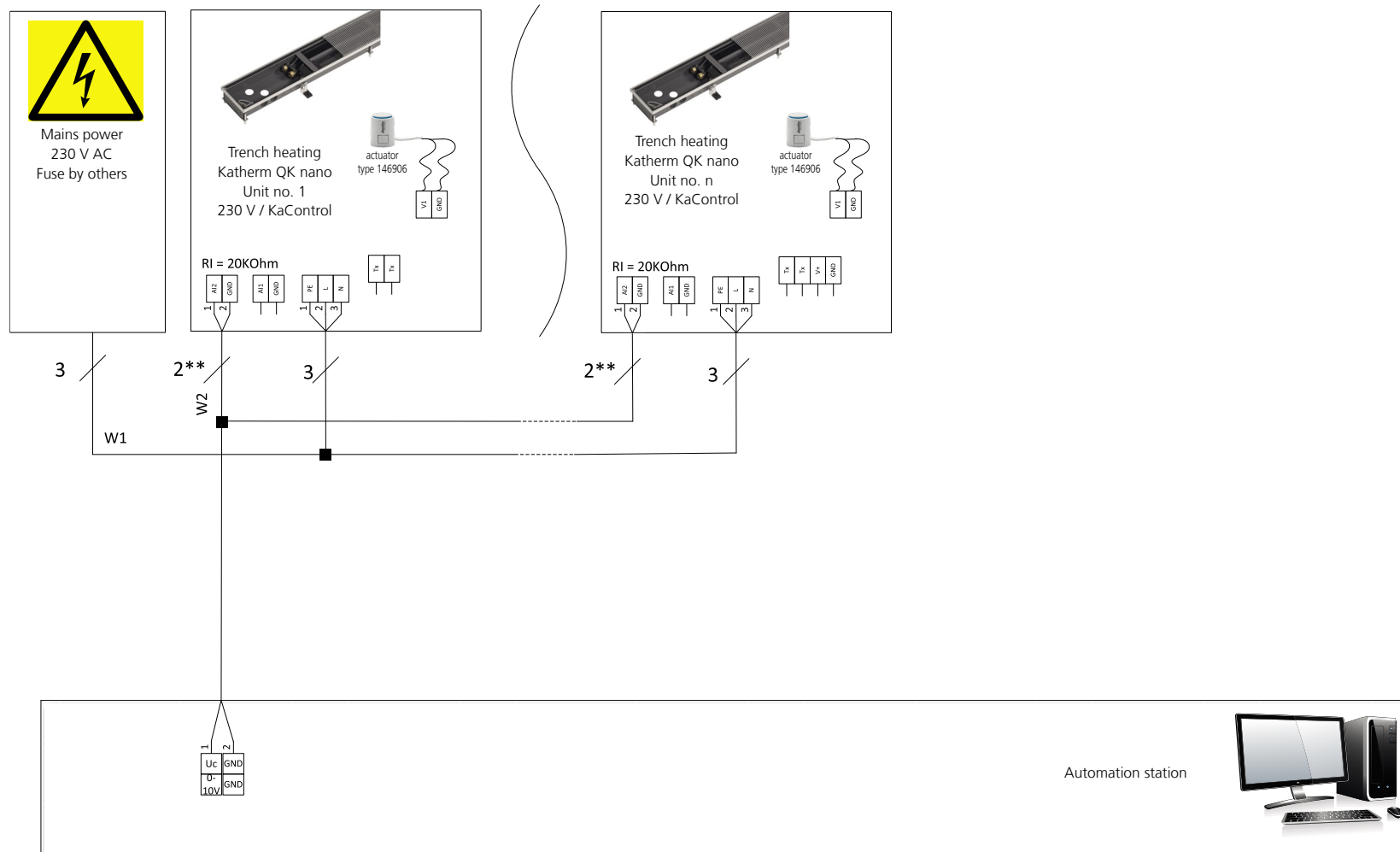

** Lay shielded, paired cables, e.g. CAT5 (AWG23) of at least the same value, separately from high-voltage cables.

W1: Power supply

W2: Control signal for fan and actuator.

Subject to technical modifications: Refer to the control accessory documentation in the event of deviation from the circuit diagrams!