

Technische Zeichnungen, Katherm ID (B340, H180), Abmessungen [mm] / Technical drawings, Katherm ID (B340, H180), Dimensions [mm]

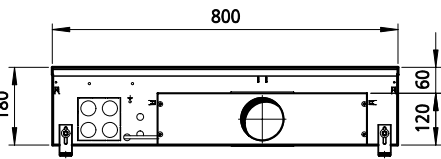

Vorderansicht / Front view

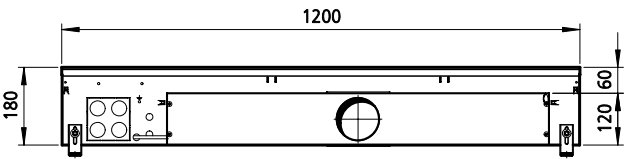

Vorderansicht / Front view

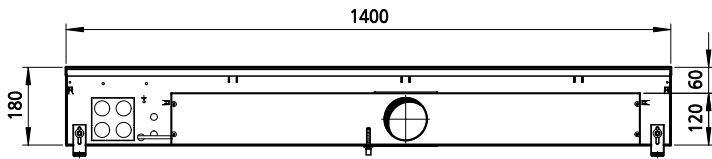

Vorderansicht / Front view

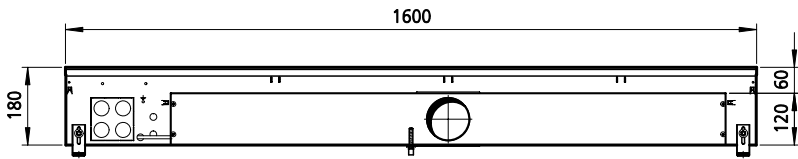

Vorderansicht / Front view

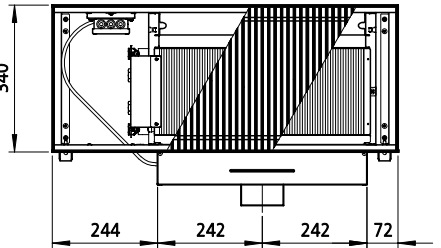

Draufsicht / Top view

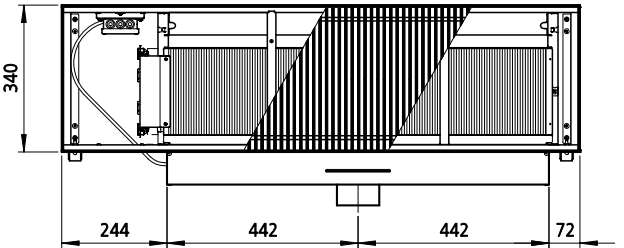

Draufsicht / Top view

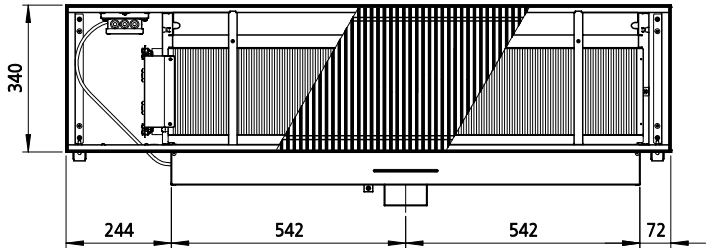

Draufsicht / Top view

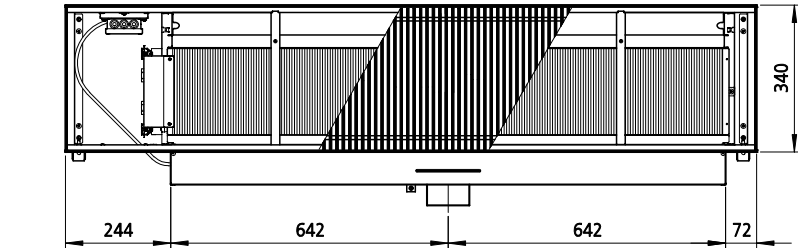

Draufsicht / Top view

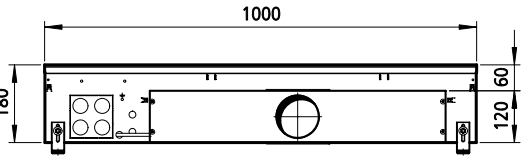

Vorderansicht / Front view

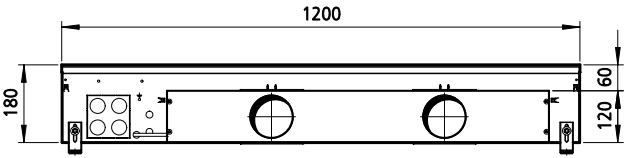

Vorderansicht / Front view

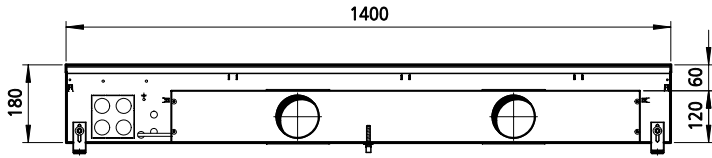

Vorderansicht / Front view

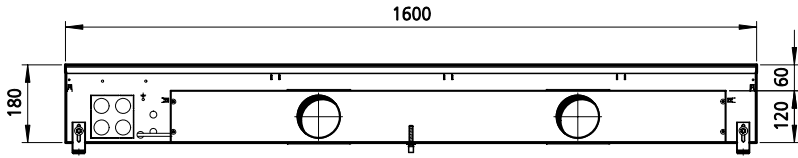

Vorderansicht / Front view

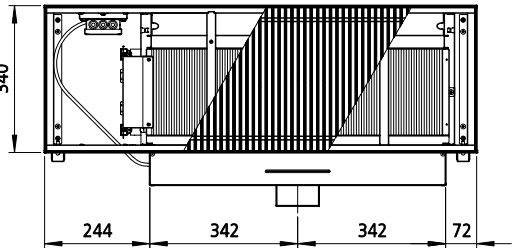

Draufsicht / Top view

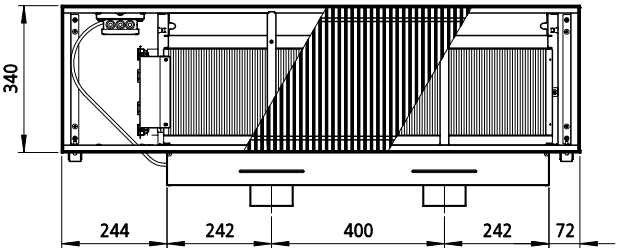

Draufsicht / Top view

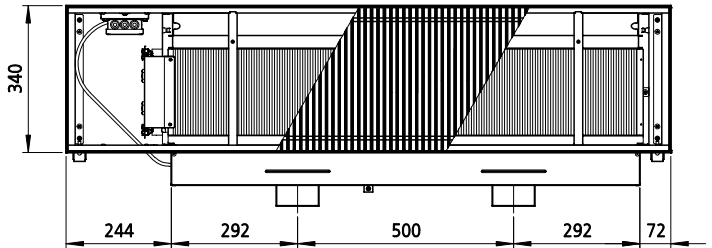

Draufsicht / Top view

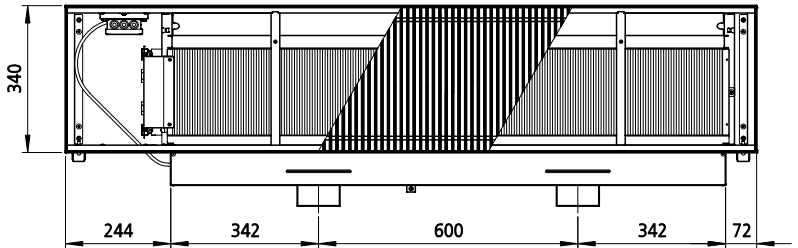

Draufsicht / Top view

Details, Beispiel 2-Leiter  
Details, example 2-pipe

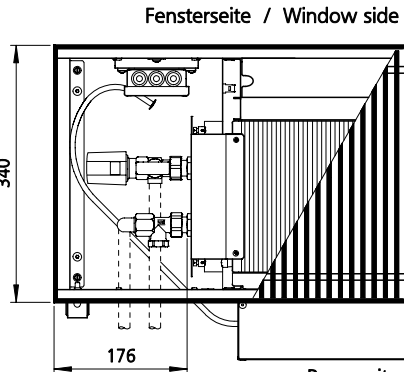

Draufsicht mit Ventilkit (optional)  
Top view with valve kit (optional)

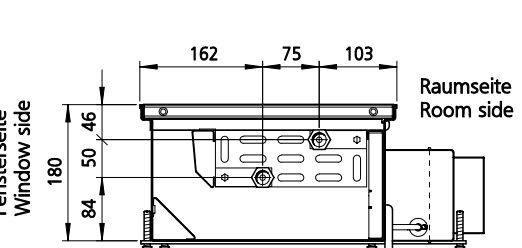

Schnitt / Cross-section

Details, Beispiel 4-Leiter  
Details, example 4-pipe

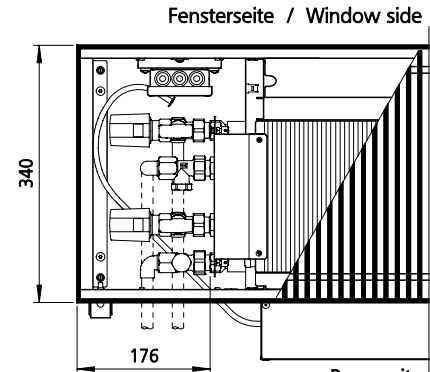

Draufsicht mit Ventilkit (optional)  
Top view with valve kit (optional)

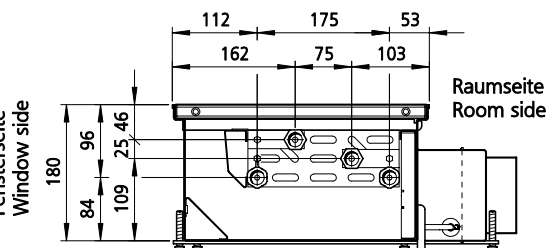

Schnitt / Cross-section

Details, Beispiel für 2- und 4-Leiter  
Details, example for 2- and 4-pipe

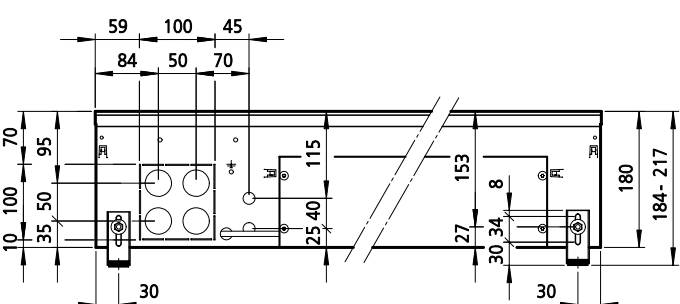

Vorderansicht / Front view

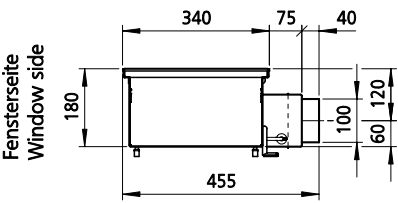

Seitenansicht für Längen 800 / 1000 / 1200 mm  
Side view for lengths 800 / 1000 / 1200 mm

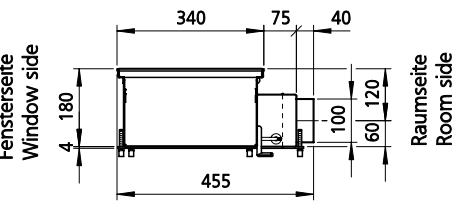

Seitenansicht für Längen 1400 / 1600 mm  
Side view for lengths 1400 / 1600 mm

Draufsichten ohne Anschlussabdeckung / Top views without cover plate

					Datum	Name	Format	Art-Gr.	Version	CAD-Nr.
					Erst.	26.10.21	SW	3	241	1
					Änder.	16.11.21	SW			
					<b>KAMPMANN</b>					
					49794 Lingen (Ems)					
					Tel. (0591) 7108-0 • Fax 7108-300					
					eMail: info@kampmann.de					
					Internet: www.kampmann.de					
					Angeb.-Nr.					
					Auftr.-Nr.					
					CAD-Zeichnung					
					Ansichten					
					Katherm ID					
					Abmessungen					
Index	Änderung	Datum	Name	Zul.Abw.	ISO 2768-m	Bereich	Dokumentation	Maßstab	1:17,5	Blatt